

# Seal Design Variations

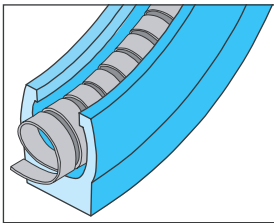

Saint-Gobain Performance Plastics offers the industry's most complete line of spring energiser configurations.

**OmniSeal 103A Spring Design**



**OmniSeal 400A Spring Design**

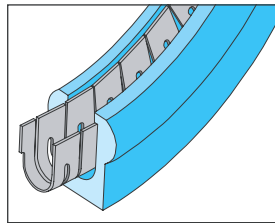

**OmniSeal APS Spring Design**

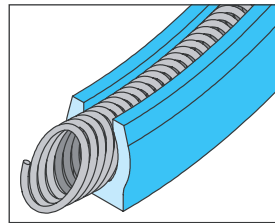

**OmniSeal RPII Spring Design**

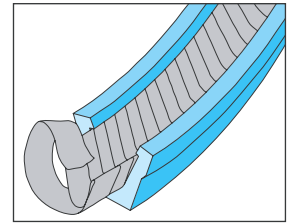

**OmniSeal RACO 1100A Spring Design**

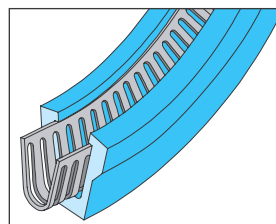

## Skived Lip

All OmniSeal designs except OmniSeal RP II can be supplied with a sharp edge on either the I.D. or O.D. sealing lip. This edge provides a scraper/wiper action for sealing abrasive or viscous media. May also be used as an environmental excluder.



## Extended Heel

OmniSeal seals can be supplied with an extended heel section for improved resistance to extrusion at high temperatures and/or high pressures. See page 14 for material selection guidance.



## Flanged Heel

The flanged heel design is recommended for rotary/oscillatory shaft applications. The flange is clamped in the seal housing to prevent the seal from turning with the shaft.

